

AMERICAN MOTORS PARTS CATALOG

GROUP 8 BRAKES - WHEELS

DESCRIPTION	GROUP AND FIGURE NO.	GROUP NO.
ADAPTER, Hydrovac Fitting	8.595
ANCHOR, Brake Pedal Return Spring	5-5	8.168
BEARING, Front Wheel	8-10	8.292
BEARING, Rear Wheel	8-12	8.300
BELLCRANK, Hand Brake Cable	8.187
BELLCRANK, Treadle Vac Operating	8-14	8.430
BLOCK, Brake Shoe Anchor Pin Guide Plate	8-1, 8-2, 8-2A, 8-2B	8.022
BODY, Treadle Vac Master Cylinder	8-15	8.510
BODY ASSEMBLY, Hydrovac Valve.....	8-16	8.555
BOLT, Brake Pedal to Link	8-14	8.156
BOLT, Wheel to Hub	8.288
BOOT, Handbrake Lever to Adjusting Yoke Cable	8-8	8.192
BRACE, Brake Master Cylinder	8-4	8.036
BRACKET, Hand Brake Cable Bellcrank	8.189
BRACKET, Hydrovac Mounting	8.590
BRACKET, Rear Brake Cable Guide	8.224
BRACKET, Rear Brake Tube	8-6, 8-7	8.112
BRACKET, Treadle Vac	8-14	8.410
BUMPER, Rear Brake Cable Equalizer	8-9	8.214
BUSHING, Spare Wheel Carrier Support Shaft	8-13	8.360
CABLE, Hand Brake Lever to Adjusting Yoke	8-8	8.192
CABLE, Rear Brake Yoke to Wheels	8-9	8.220
CABLE ASSEMBLY, Brake Shoe Automatic Adjusting	8-2, 8-2A, 8-2B	8.010
CAP, Hydrovac Hydraulic Cylinder	8-16	8.560
CAP, Wheel Hub	8-10, Refer Group 0	8.274
CHAIN, Spare Wheel Carrier	8-13	8.350
CLAMP, Spare Wheel	8.330
CLEANER, Treadle Vac Air	8-15	8.450
CLIP, Brake Tube	8-6, 8-7	8.101
CLIP, Hand Brake Cable	8-8	8.192
CLIP, Treadle Vac Vacuum Hose	8-14	8.470
COVER, Brake Adjusting Hole	8-1, 8-2, 8-2A, 8-2B, 8-2D, 8-3	8.030
COVER, Brake Pedal Pad	8-14, 5-5	8.148
COVER, Hand Brake Lever Rubber	8-8	8.180
COVER, Spare Wheel Tire	8.380
COVER, Treadle Vac Air	8.450
COVER, Treadle Vac Vacuum Cylinder	8-15	8.485
COVER, Wheel Hub	8-11, Refer Group 0	8.274
CUP, Front Wheel Bearing	8-10	8.294
CUP, Rear Wheel Bearing	8-12	8.302
CUSHION, Brake Pedal Stop Sponge Rubber	8.172
CYLINDER, Hydrovac Vacuum	8-16	8.585
CYLINDER ASSEMBLY, Brake Master	8-4, 8-7	8.035
CYLINDER ASSEMBLY, Brake Wheel	8-1, 8-2, 8-2A, 8-2B, 8-2D, 8-3, 8-5, 8-7	8.068
CYLINDER ASSEMBLY, Spare Wheel Lock	8.375
DIAPHRAGM, Treadle Vac Poppet	8-15	8.482
DRUM, Brake	8-11	8.245
DRUM ASSEMBLY, Brake (Incl. Hub)	8-10	8.240
ECCENTRIC, Brake Shoe	8.020
EQUALIZER, Rear Brake Cable	8-9	8.214
FITTING, Brake Master Cylinder	8-4, 8-6, 8-7	8.040
FITTING, Front Brake Tube 5-Way	8-7	8.102
FITTING, Treadle Vac Master Cylinder Outlet	8-14, 8-15	8.520
GASKET, Treadle Vac Master Cylinder	8-15	8.500

AMERICAN MOTORS PARTS CATALOG

DESCRIPTION	GROUP AND FIGURE NO.	GROUP NO.
GUARD, Treadle Vac Valve Rod	8-15	8.480
GUIDE, Brake Shoe Automatic Adjusting Cable	8-2, 8-2B, 8-2C	8.011
GUIDE, Rear Brake Cable	8-9	8.224
HAIR, Treadle Vac Air Cleaner	8.450
HANDLE, Parking Brake Lever	8-8	8.180
HINGE, Spare Wheel Carrier Support	8-13	8.350
HOSE, Brake Tube	8-6, 8-7	8.116
HOSE, Treadle Vac Vacuum	8-14	8.475
HUB, Wheel	8-11	8.243
HYDROVAC ASSEMBLY, Power Brake	8-16	8.550
KEY, Spare Wheel Lock Cylinder	8.376
LEVER, Brake Shoe Automatic Adjusting	8-2, 8-2B, 8-2C	8.012
LEVER, Brake Shoe Hand Brake	8-2A, 8-2B, 8-3	8.024
LEVER, Parking Brake	8-8, 0-14	8.180
LINING SET, Brake Shoe	8.006
LINK, Brake Master Cylinder Connecting	8-4	8.054
LINK, Brake Pedal to Brake Master Cylinder	8.152
LINK, Brake Shoe to Cylinder Operating	8-1, 8-2, 8-2A, 8-2B, 8-2D, 8-3, 8-5	8.016
LINK, Treadle Vac Piston Rod Adjusting	8-14	8.420
LOCK, Spare Wheel	8.375
LOCK, Spare Wheel Carrier	8-13	8.370
NUT, Brake Shoe Adjusting Screw	8-1, 8-2, 8-2A, 8-2B, 8-2C, 8-2D, 8-3	8.014
NUT, Wheel to Hub Stud	8-10	8.286
PAN, Brake Pedal Splash	8.175
PEDAL, Brake	8-14, 5-5	8.140
PISTON, Hydrovac Hydraulic (Master)	8-16	8.575
PISTON SET, Brake Wheel Cylinder	8-1, 8-2, 8-2A, 8-2B, 8-2D, 8-5	8.078
PLATE, Brake Master Cylinder Piston Stop	8-4	8.046
PLATE, Brake Shoe Anchor Guide	8-1, 8-2, 8-2A, 8-2B, 8-2C, 8-2D, 8-3	8.022
PLATE, Front Brake Support	8-1, 8-2, 8-2D	8.001
PLATE, Rear Brake Support	8-2A, 8-2B, 8-3, 8-12	8.002
PLATE, Rear Wheel Guide	8-12	8.310
PLATE, Treadle Vac Poppet	8-15	8.482
PLATE, Treadle Vac Vacuum Cylinder Shell	8-15	8.490
PLATE ASSEMBLY, Hydrovac Cylinder and Valve End	8-16	8.570
PLUG, Brake Master Cylinder Filler	8-4	8.038
PLUNGER, Treadle Vac Valve	8-15	8.480
POPPET, Treadle Vac	8-15	8.482
REPAIR KIT, Brake Master Cylinder	8-4	8.048
REPAIR KIT, Brake Wheel Cylinder	8-1, 8-2, 8-2A, 8-2B, 8-2D, 8-5	8.080
REPAIR KIT, Hydrovac	8.552
REPAIR KIT, Treadle Vac	8-15	8.405
REPLACEMENT KIT, Treadle Vac Poppet	8.405
RETAINER, Front Wheel Grease	8-10	8.296
ROD, Hydrovac Vacuum Piston	8-16	8.580
ROD, Rear Brake Cable Adjusting	8.214
ROD, Treadle Vac Valve	8-15	8.480
ROD ASSEMBLY, Brake Pedal	5-5	8.145
ROD ASSEMBLY, Treadle Vac Master Cylinder Piston	8-15	8.505
SCREW, Brake Shoe Adjusting	8-1, 8-2, 8-2A, 8-2B, 8-2C, 8-2D, 8-3	8.014
SCREW, Brake Tube Clip	8-6	8.101
SCREW, Wheel Cylinder Bleeder	8-1, 8-2, 8-2A, 8-2B, 8-2D, 8-5	8.088
SEAL, Rear Wheel Oil	8-12	8.312
SEAL, Treadle Vac Valve Rod	8-15	8.480
SHAFT, Brake Pedal	8-14	8.160
SHELL, Treadle Vac Vacuum Cylinder	8-15	8.500

AMERICAN MOTORS PARTS CATALOG

DESCRIPTION	GROUP AND FIGURE NO.	GROUP NO.
SHIM, Rear Wheel Bearing	8-12	8.315
SHOE SET, Brake	8-1, 8-2, 8-2A, 8-2B, 8-2D, 8-3	8.004
SOCKET, Brake Shoe Adjusting Screw	8-1, 8-2, 8-2A, 8-2B, 8-2C, 8-2D, 8-3	8.014
SPACER, Brake Tube Clip	8-6	8.101
SPRING, Brake Pedal Return	5-5	8.168
SPRING, Brake Pedal Shaft	5-5	8.160
SPRING, Brake Wheel Cylinder Piston Return	8-5	8.086
SPRING, Spare Wheel Carrier Lock	8-13	8.370
SPRING, Treadle Vac Vacuum Cylinder Expander	8-15	8.490
SPRING, Treadle Vac Valve Poppet	8-15	8.480
SPRING SET, Brake Shoe	8-1, 8-2, 8-2A, 8-2B, 8-2C, 8-2D, 8-3	8.008
STRUT, Brake Shoe Parking Brake Lever	8-3	8.024
STUD, Drum to Hub	8-10	8.248
STUD, Hand Brake Lever	8.180
SUPPORT, Brake Pedal Shaft	8-14	8.164
SUPPORT, Spare Wheel Carrier	8-13	8.350
TANK, Treadle Vac Reserve	8-14	8.440
TEE, Rear Brake Tube	8-6, 8-7	8.122
TREADLE VAC, Power Brake	8-14, 8-15	8.400
TUBE, Brake Master Cylinder to Front Tube and Rear Hose ..	8-6, 8-7	8.100
TUBE, Front Brake	8-6, 8-7, 8-14	8.106
TUBE, Hydrovac to 5-Way Fitting	8.610
TUBE, Master Cylinder to Hydrovac	8.605
TUBE, Rear Brake	8-6, 8-7	8.126
U-BOLT, Rear Brake Cable Guide	8-9	8.224
VALVE, Hydrovac Check	8.600
VALVE, Treadle Vac Master Cylinder Compensating	8-15	8.515
VALVE, Treadle Vac Vacuum Check	8-14	8.460
WHEEL, Front and Rear	8-10, 8-11	8.270

AMERICAN MOTORS PARTS CATALOG

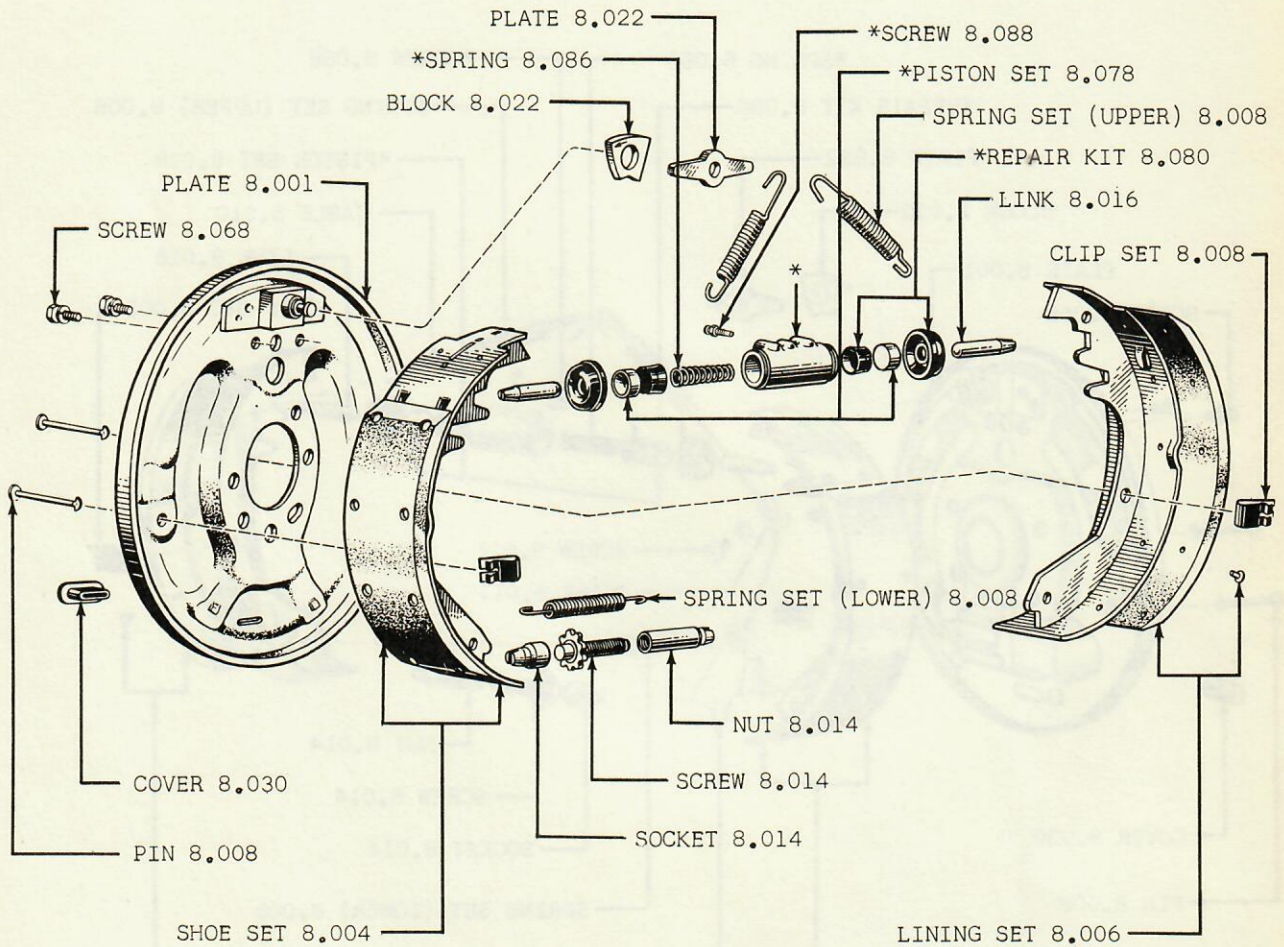

* ALSO SERVICED AS PART OF CYLINDER ASSEMBLY 8.068

GROUP 8 - FIG. 1 - FRONT BRAKE 01-10 (LAB)

AMERICAN MOTORS PARTS CATALOG

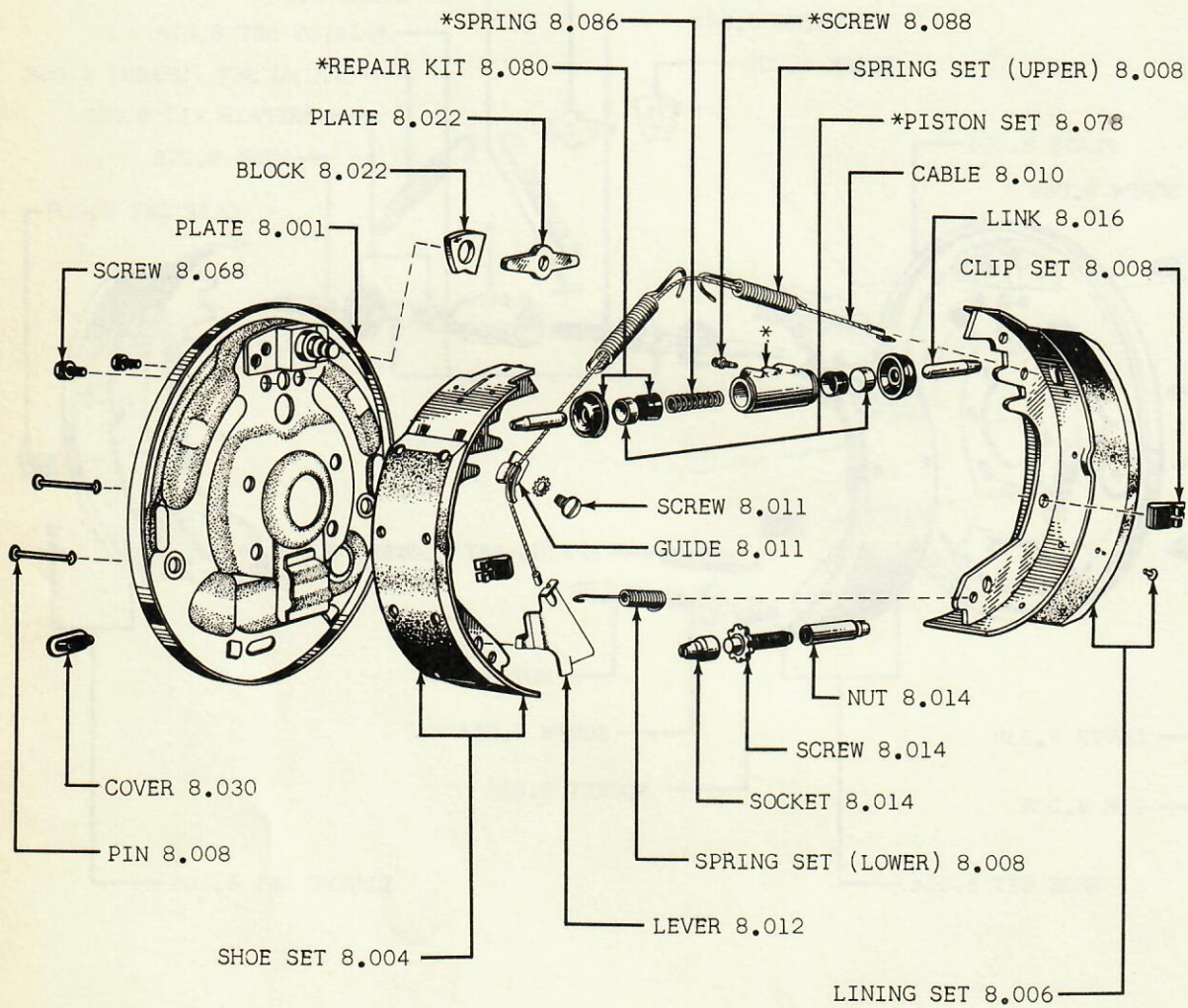

* ALSO SERVICED AS PART OF CYLINDER ASSEMBLY 8.068

GROUP 8 - FIG. 2 - FRONT BRAKE 01-10 (WAB)

AMERICAN MOTORS PARTS CATALOG

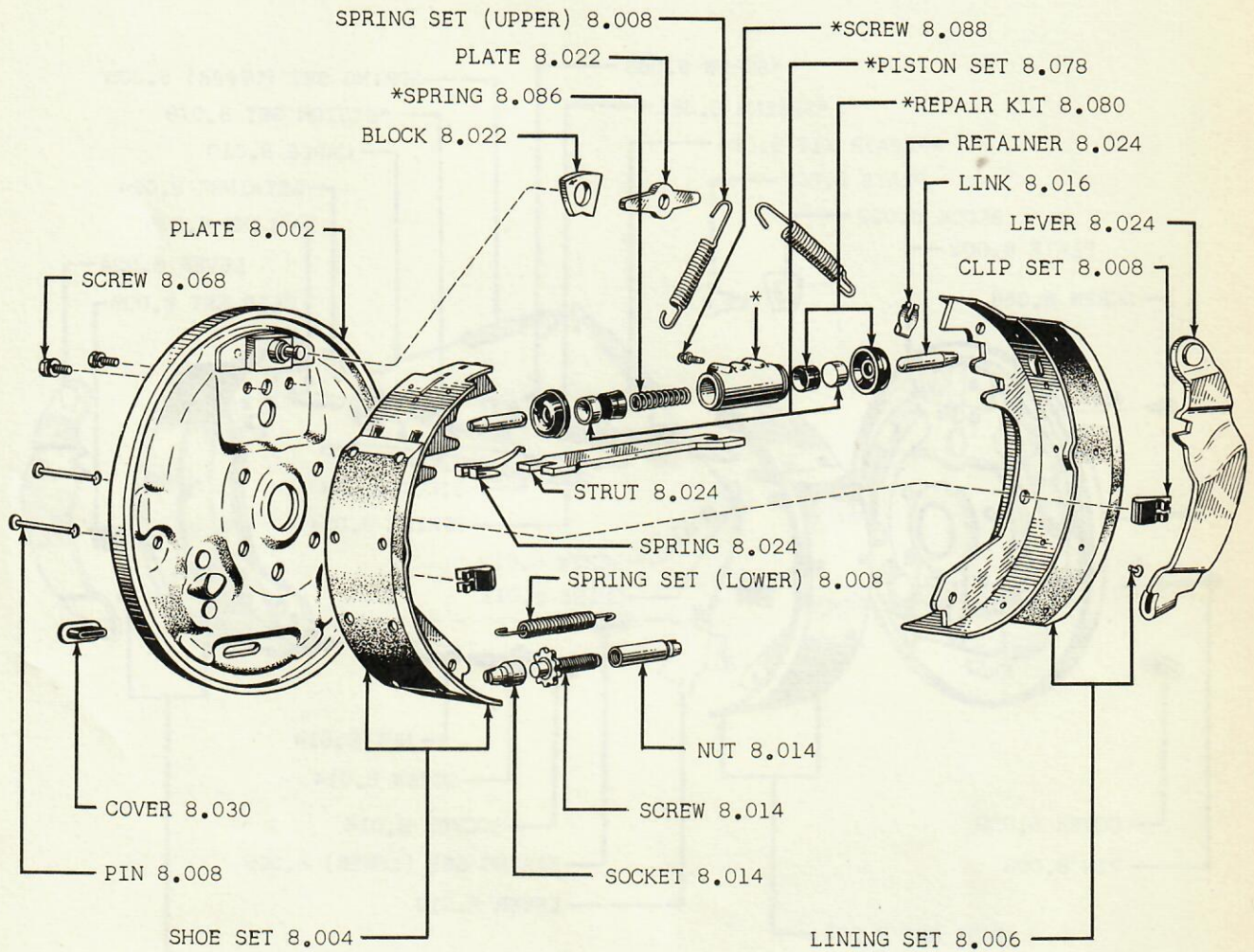

GROUP 8 - FIG. 2A - REAR BRAKE 01-10 (LAB)

AMERICAN MOTORS PARTS CATALOG

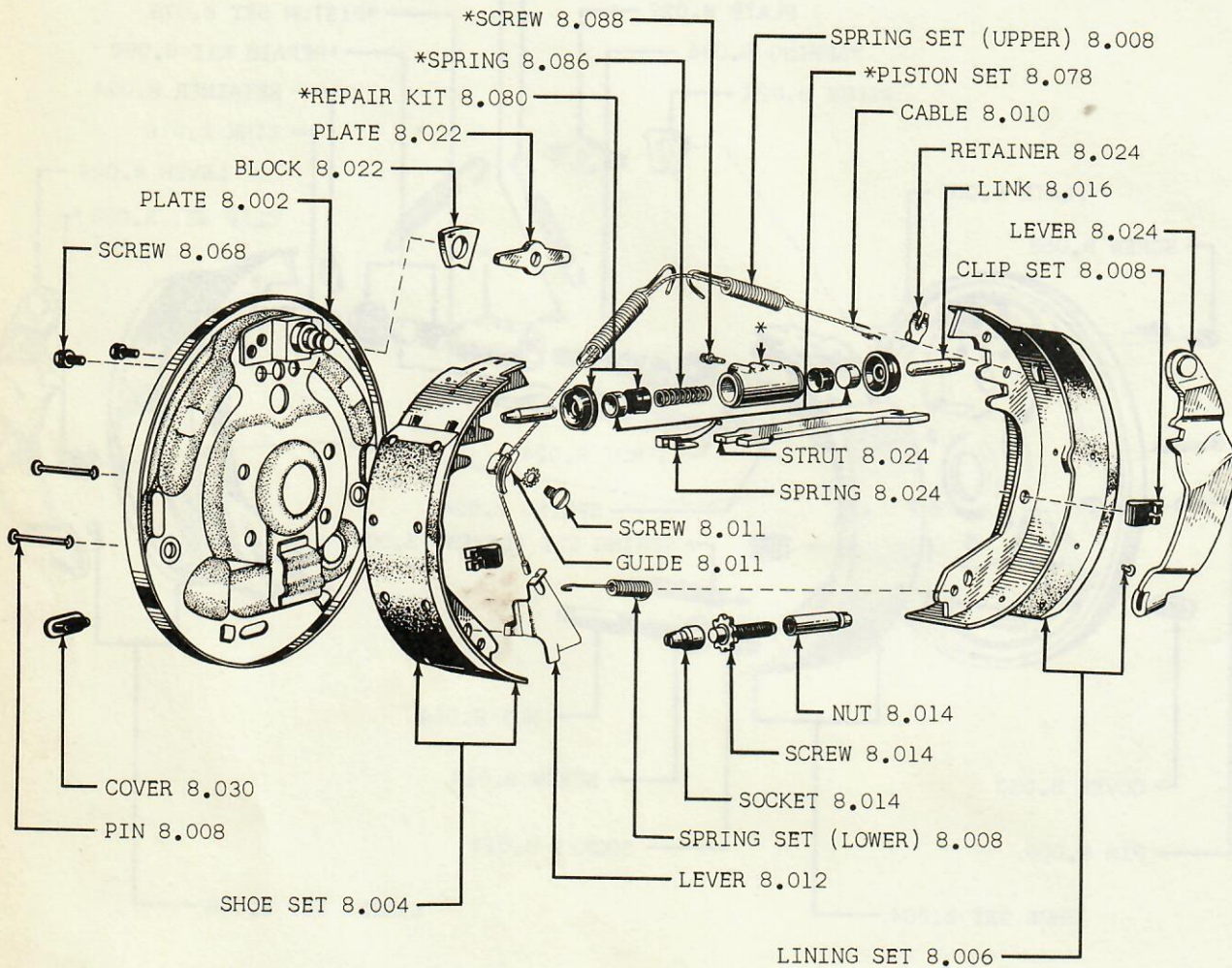

* ALSO SERVICED AS PART OF CYLINDER ASSEMBLY 8.068

GROUP 8 - FIG. 2B - REAR BRAKE 01-10 (WAB)

AMERICAN MOTORS PARTS CATALOG

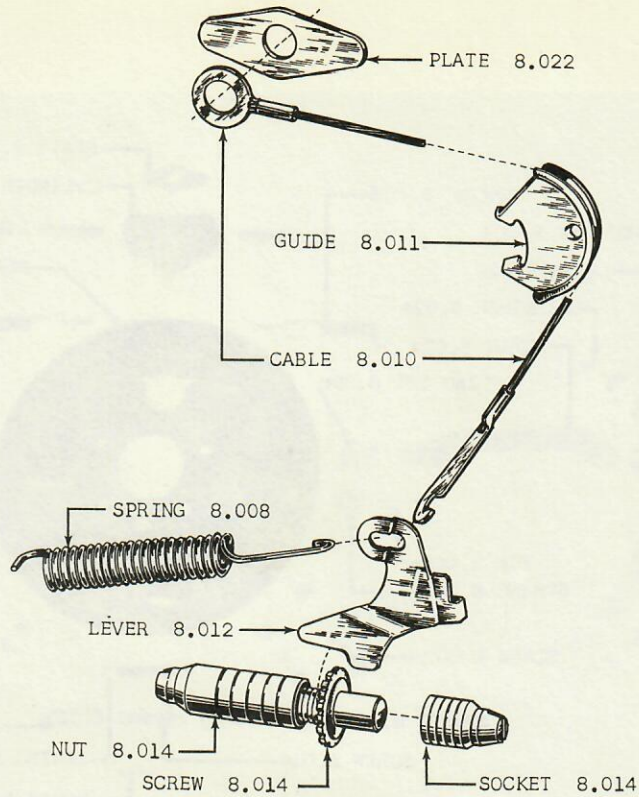

GROUP 8 - FIG. 2C - BRAKE SHOE SELF ADJUSTMENT ASSEMBLY 20-80 (WAB)

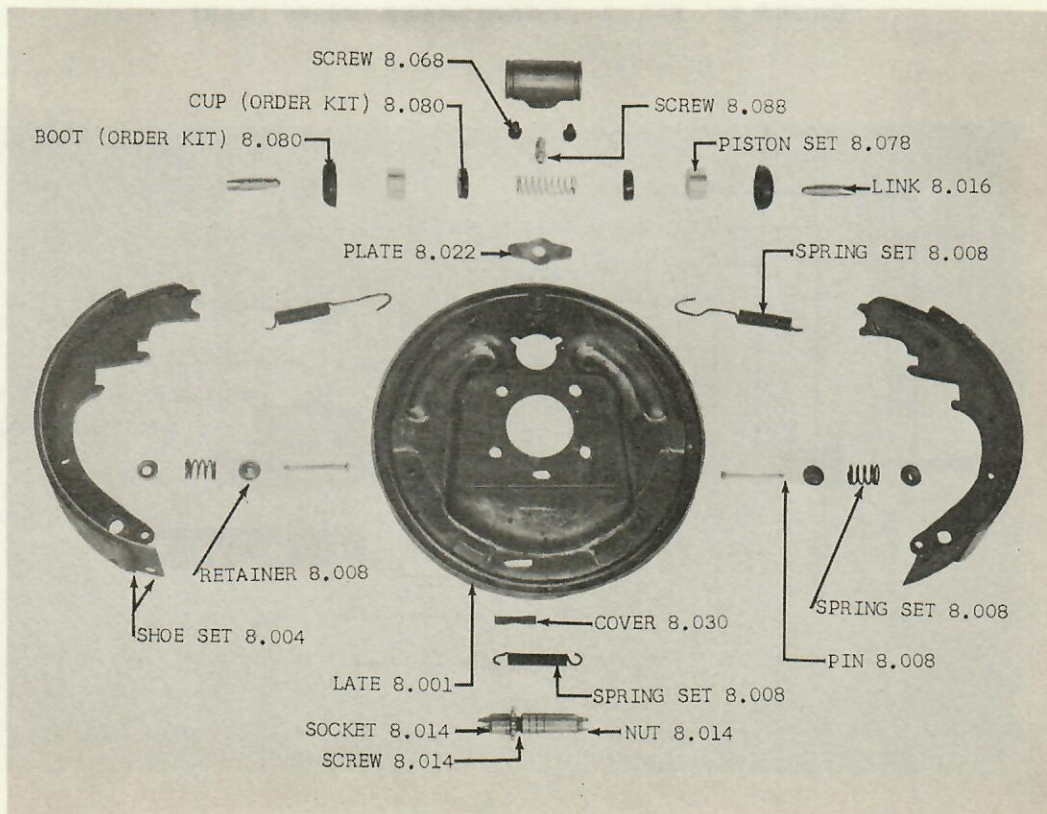

GROUP 8 - FIG. 2D - FRONT BRAKE 20-80 (LAB)

AMERICAN MOTORS PARTS CATALOG

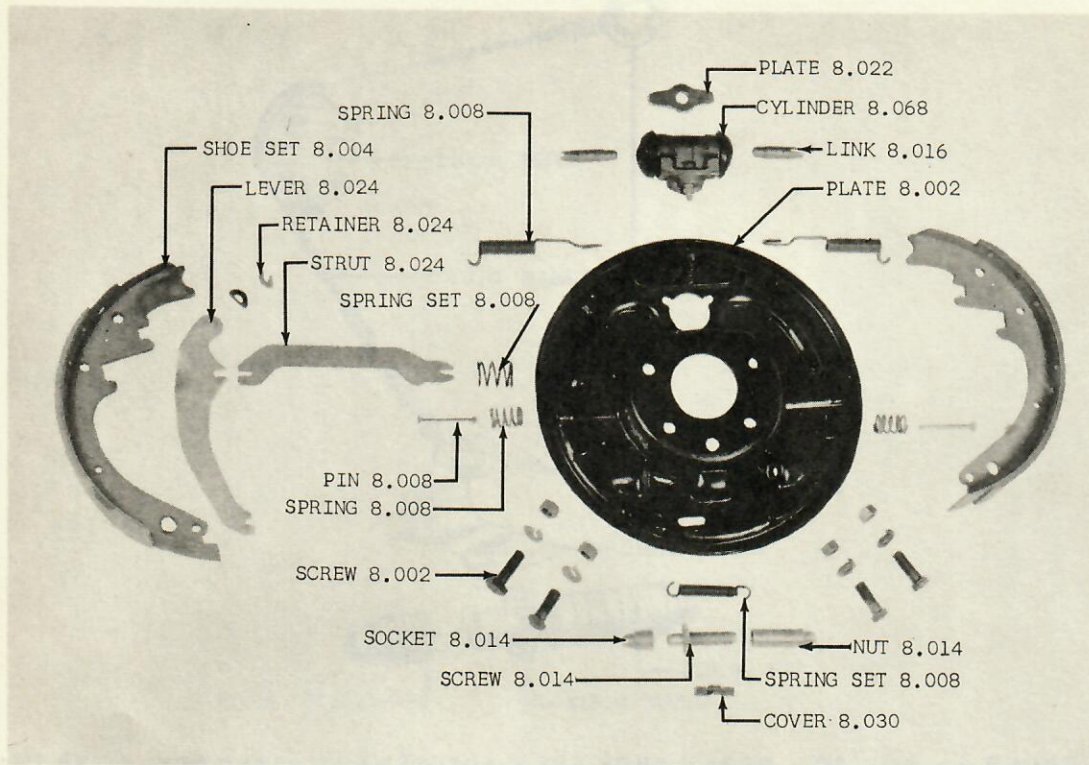

GROUP 8 - FIG. 3 - REAR BRAKE 20-80 (LAB)

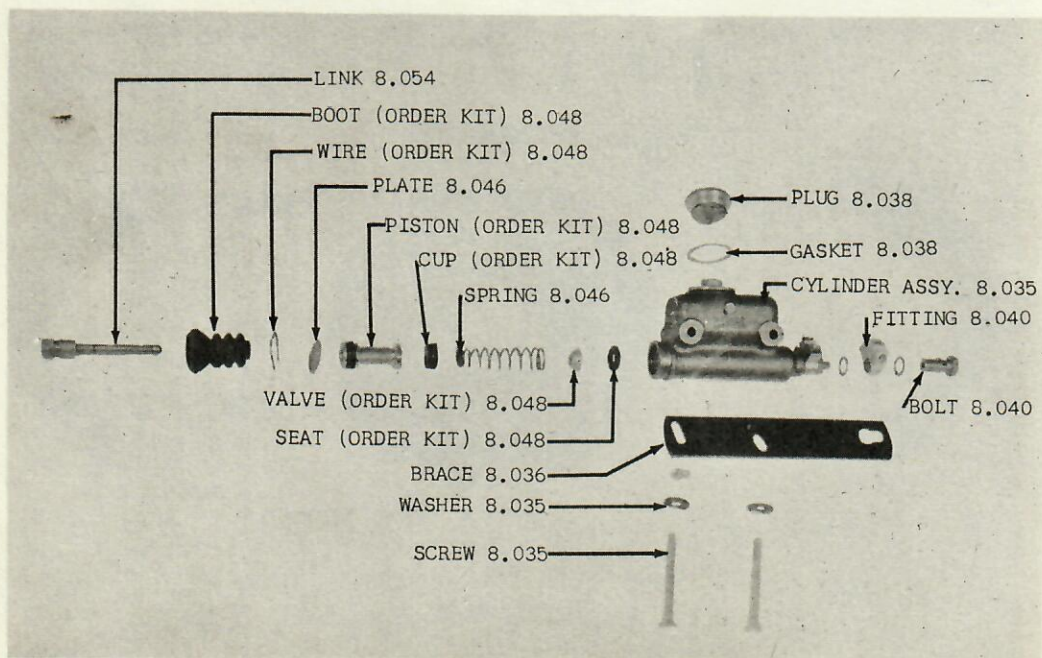

GROUP 8 - FIG. 4 - BRAKE MASTER CYLINDER 01-10-20-80 (LPB)

AMERICAN MOTORS PARTS CATALOG

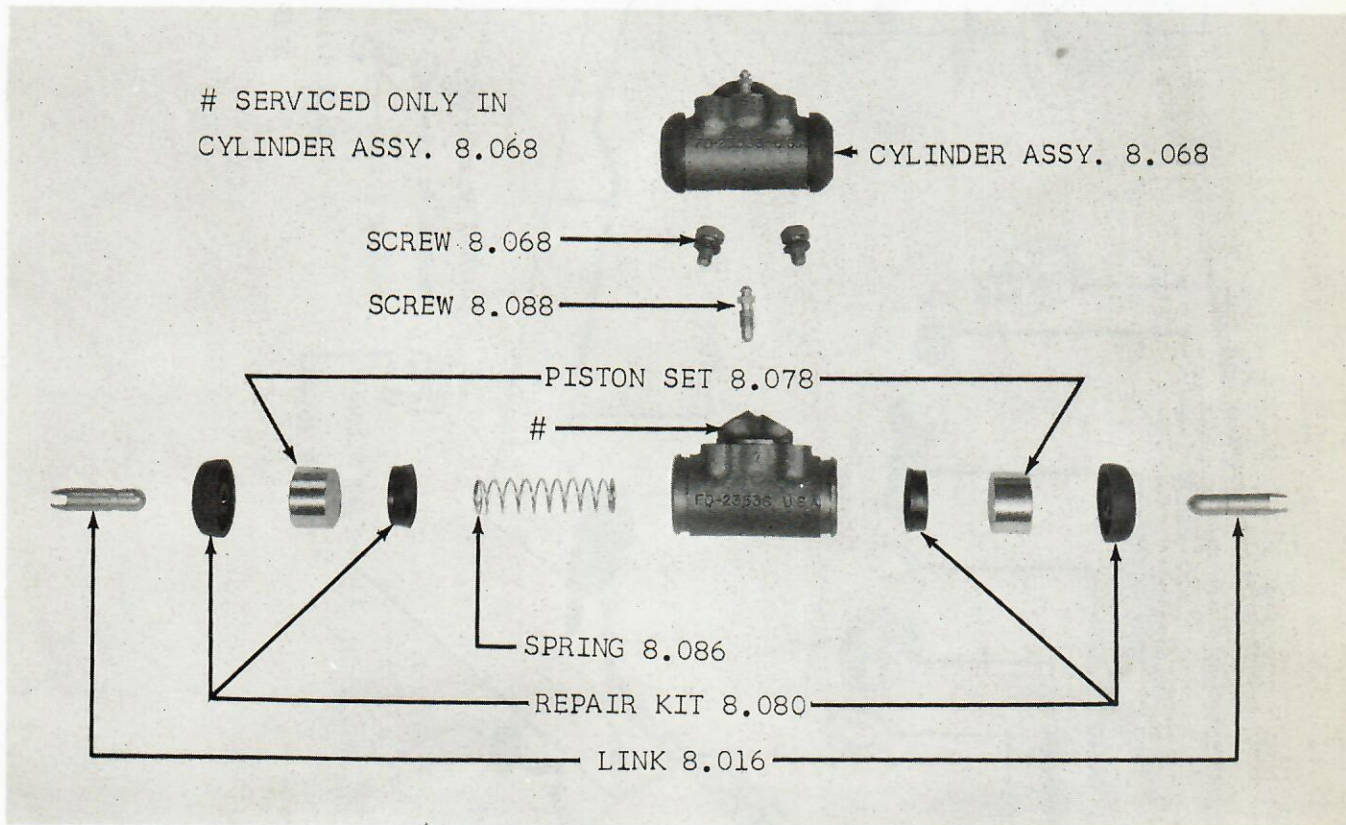

GROUP 8 - FIG. 5 - BRAKE WHEEL CYLINDER 01-10-20-80

AMERICAN MOTORS PARTS CATALOG

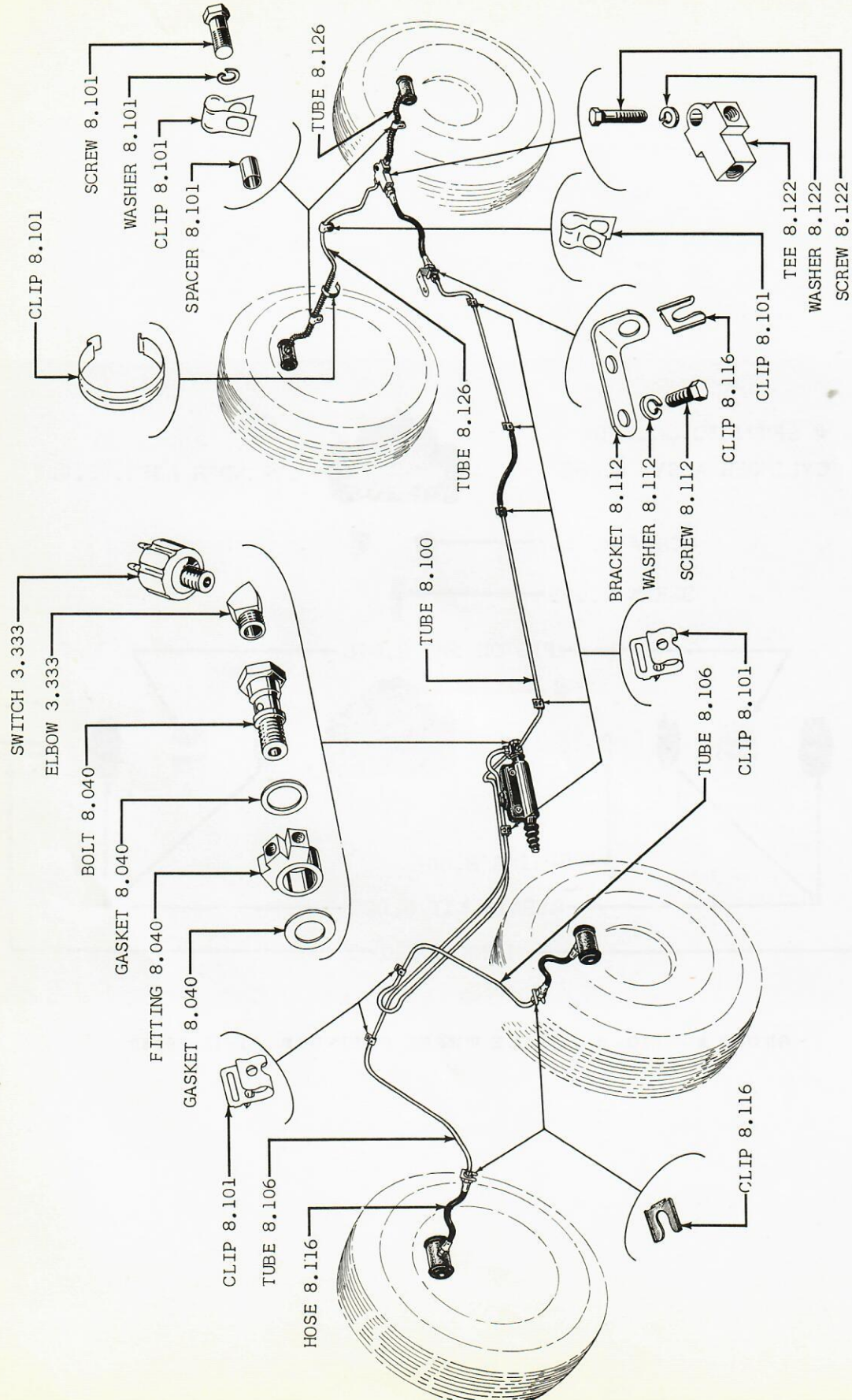

GROUP 8 - FIG. 6 - BRAKE LINES AND ATTACHING PARTS 01

AMERICAN MOTORS PARTS CATALOG

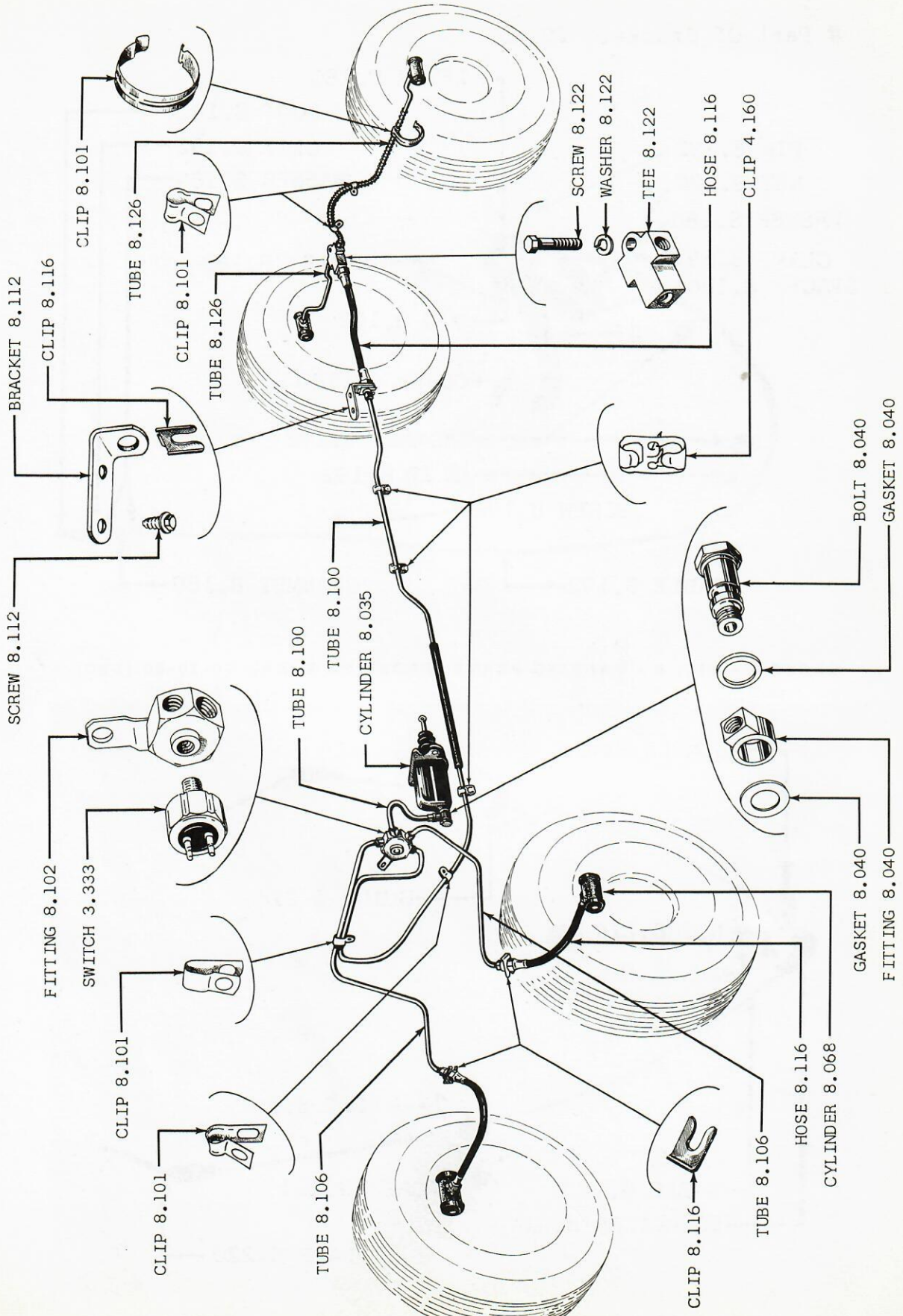

GROUP 8 - FIG. 7 - BRAKE LINES AND ATTACHING PARTS 10-20-80

AMERICAN MOTORS PARTS CATALOG

Part Of Bracket 20.155

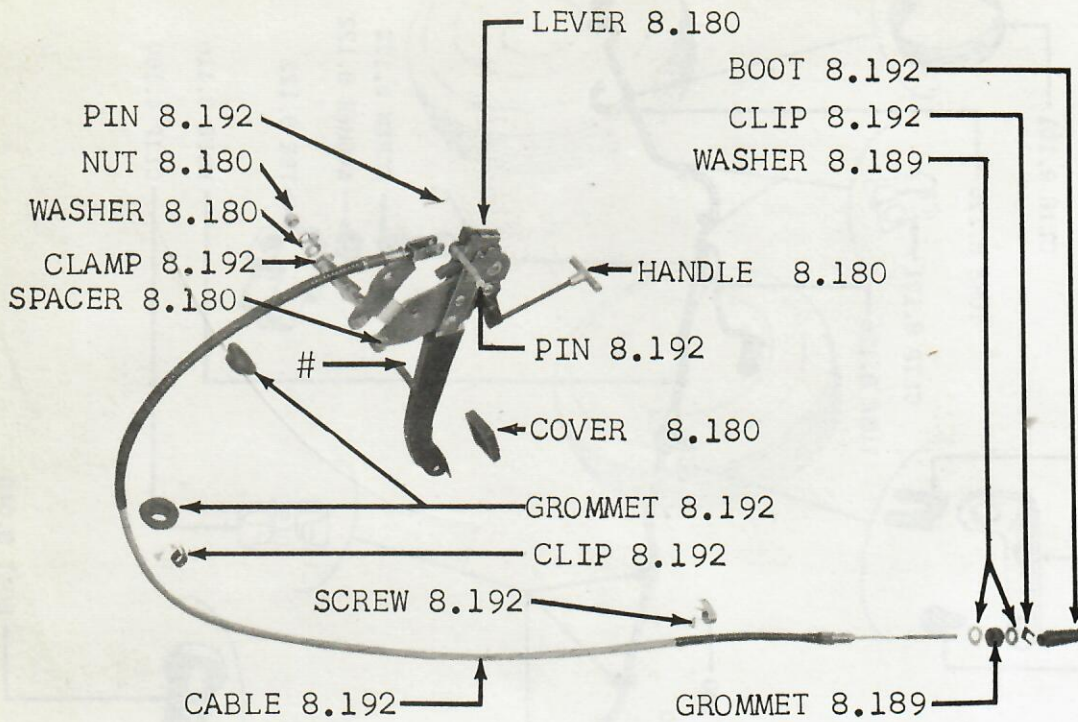

GROUP 8 - FIG. 8 - PARKING BRAKE (PEDAL TO YOKE) 10-20-80 (LHD)

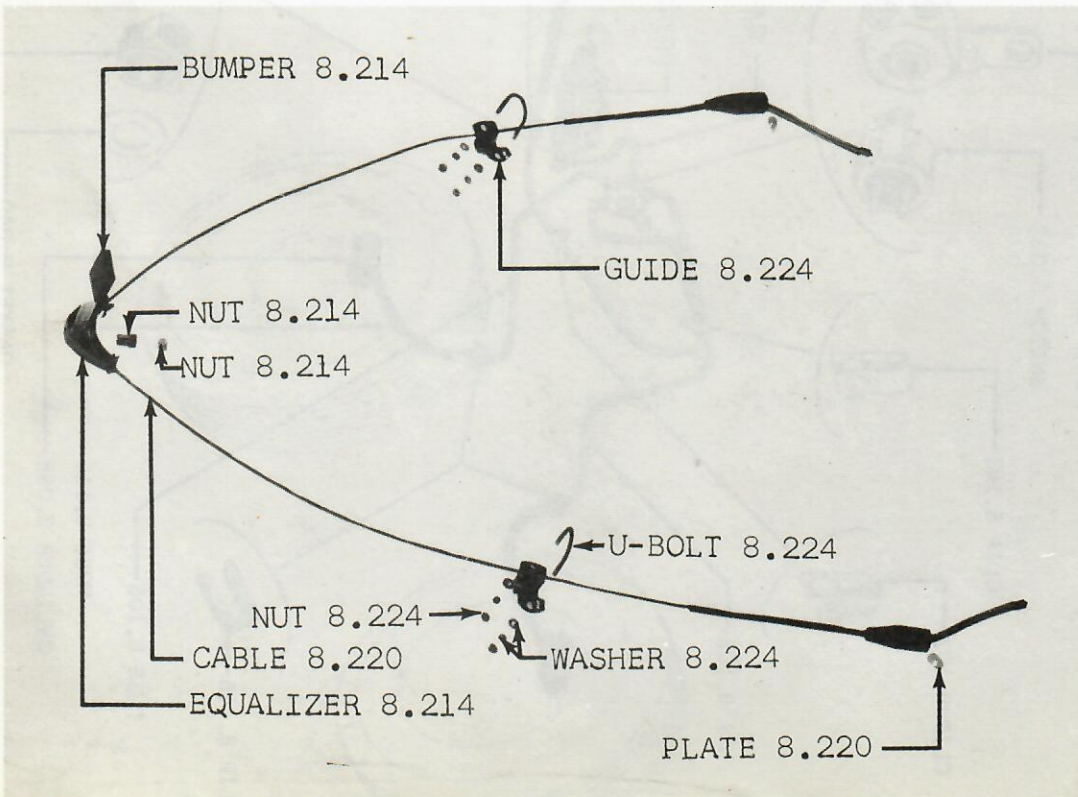

GROUP 8 - FIG. 9 - PARKING BRAKE (YOKE TO DRUM) 10-20-80 (LHD)

AMERICAN MOTORS PARTS CATALOG

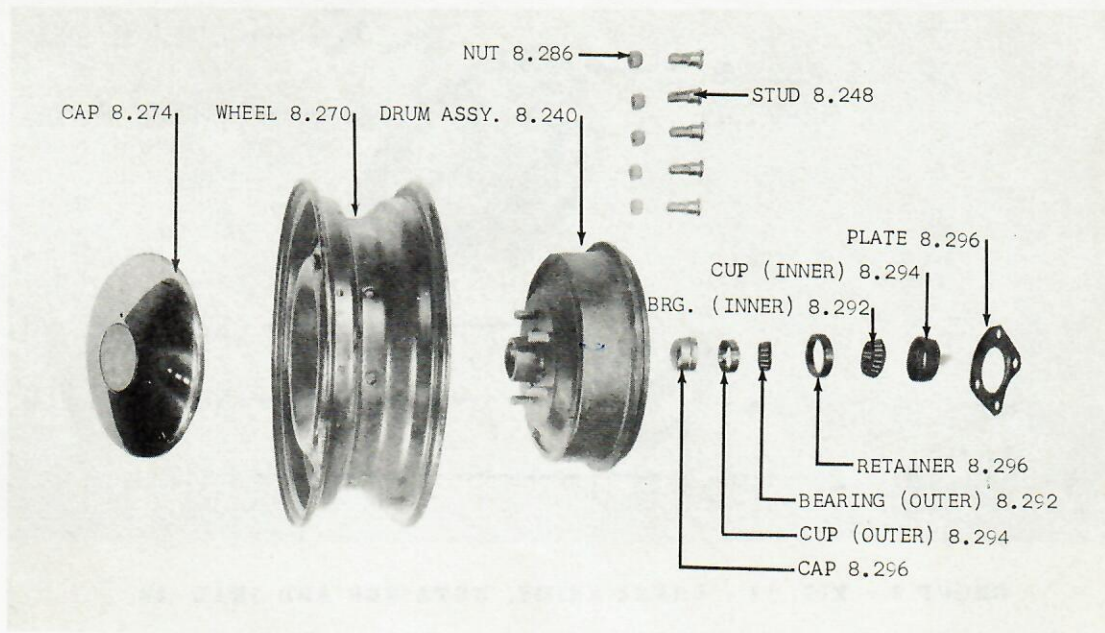

GROUP 8 - FIG. 10 - FRONT WHEEL 01-10-20-80

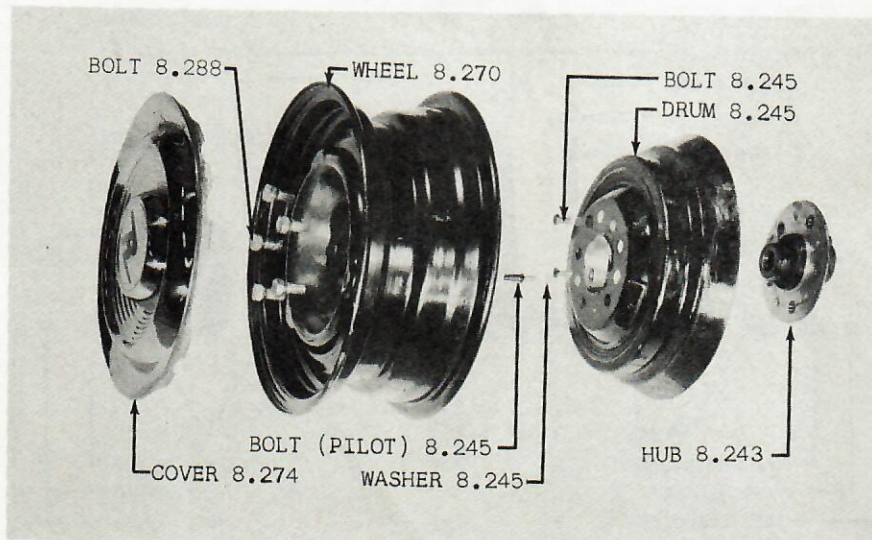

GROUP 8 - FIG. 11 - REAR HUB AND DRUM 20-80

AMERICAN MOTORS PARTS CATALOG

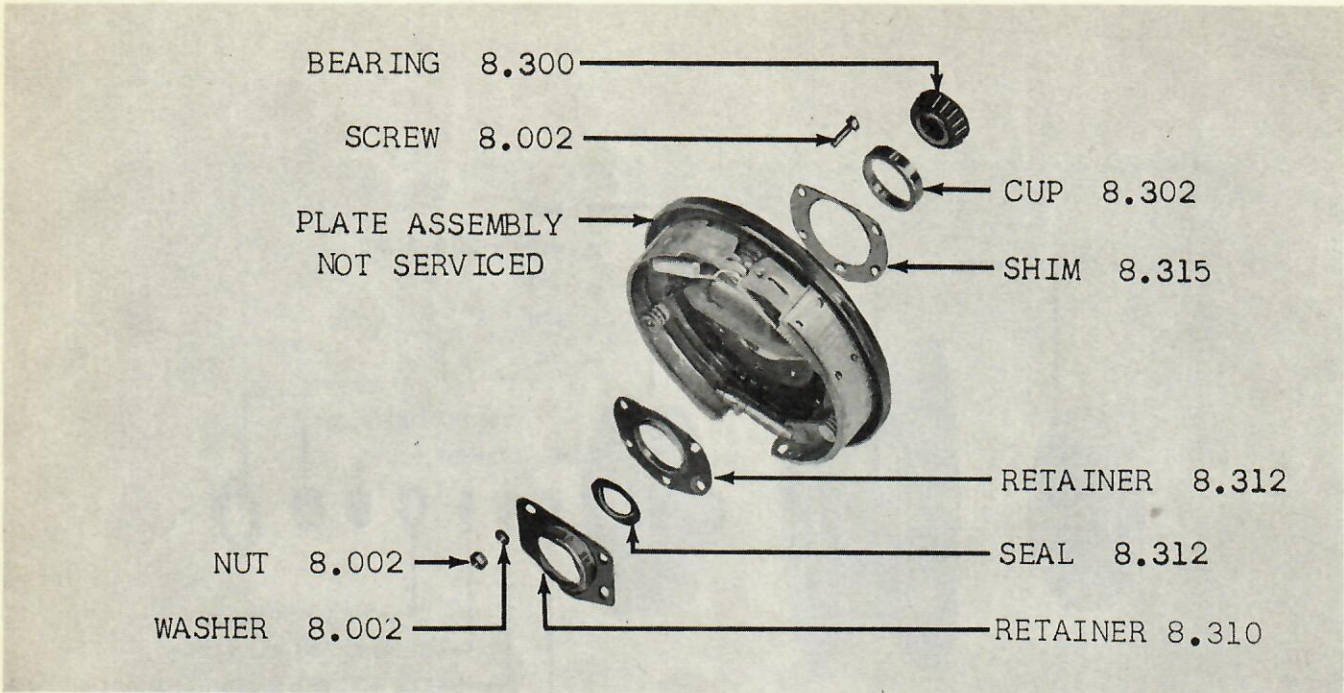

GROUP 8 - FIG. 12 - BRAKE SHIMS, RETAINER AND SEAL 20

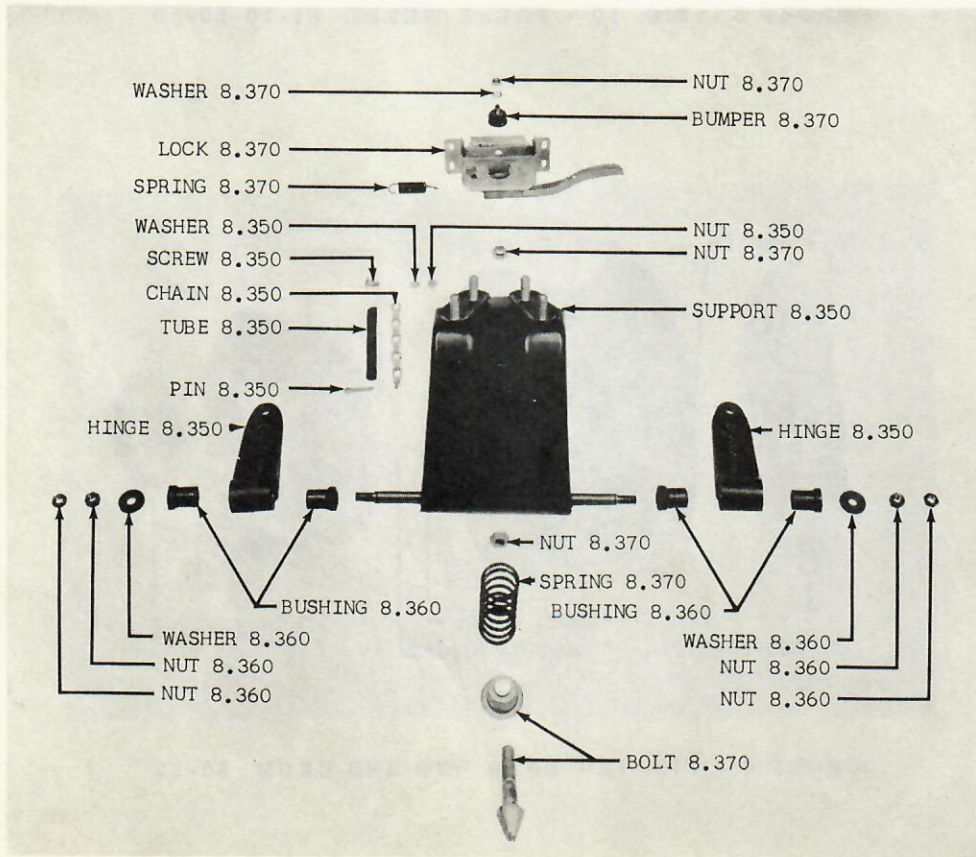

GROUP 8 - FIG. 13 - SPARE WHEEL CARRIER SUPPORT 10-20-80 (WWC)

AMERICAN MOTORS PARTS CATALOG

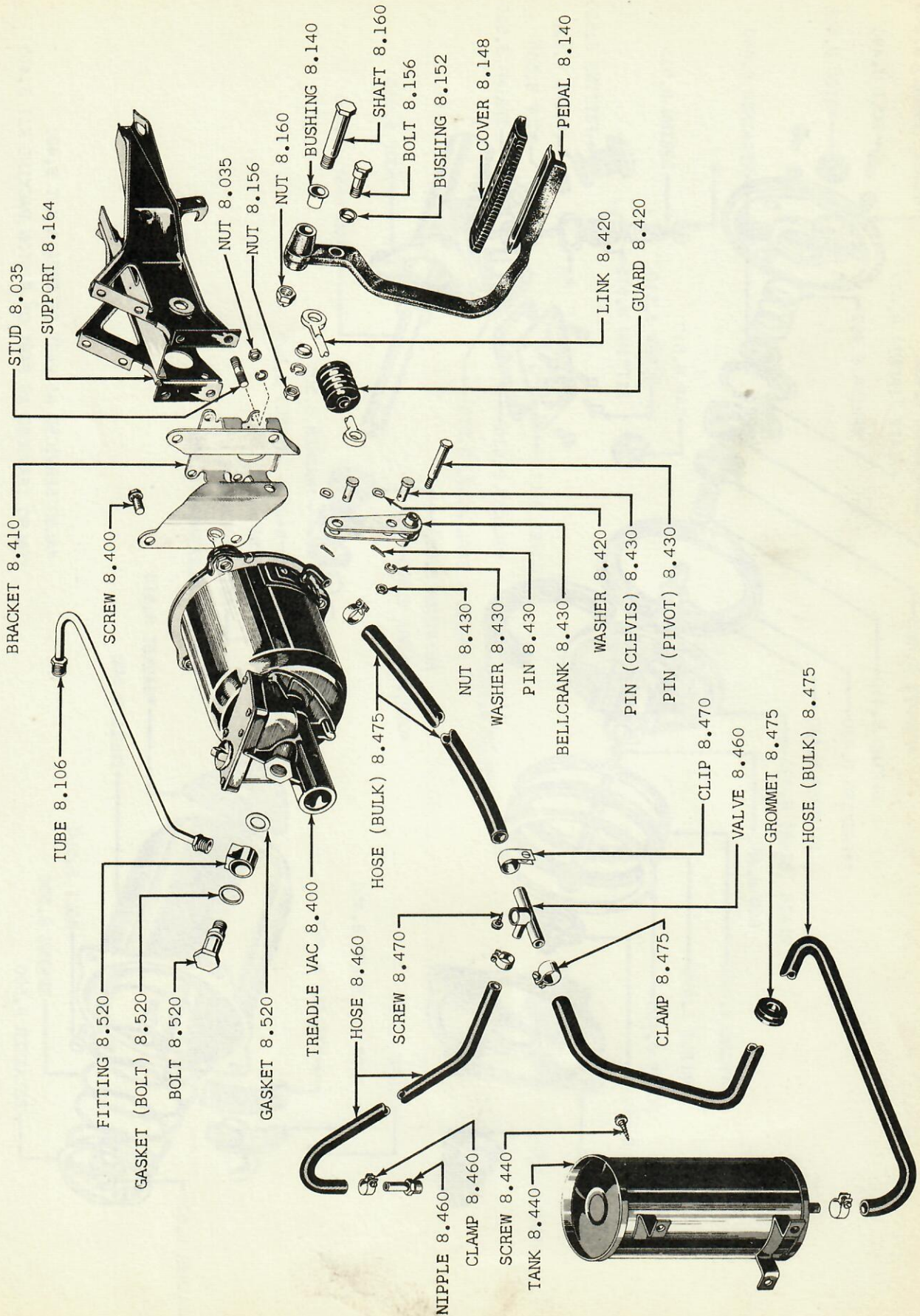

GROUP 8 - FIG. 14 - POWER BRAKE TREADLE VAC AND LINKAGE 10-20-80 (LHD-WPB)

AMERICAN MOTORS PARTS CATALOG

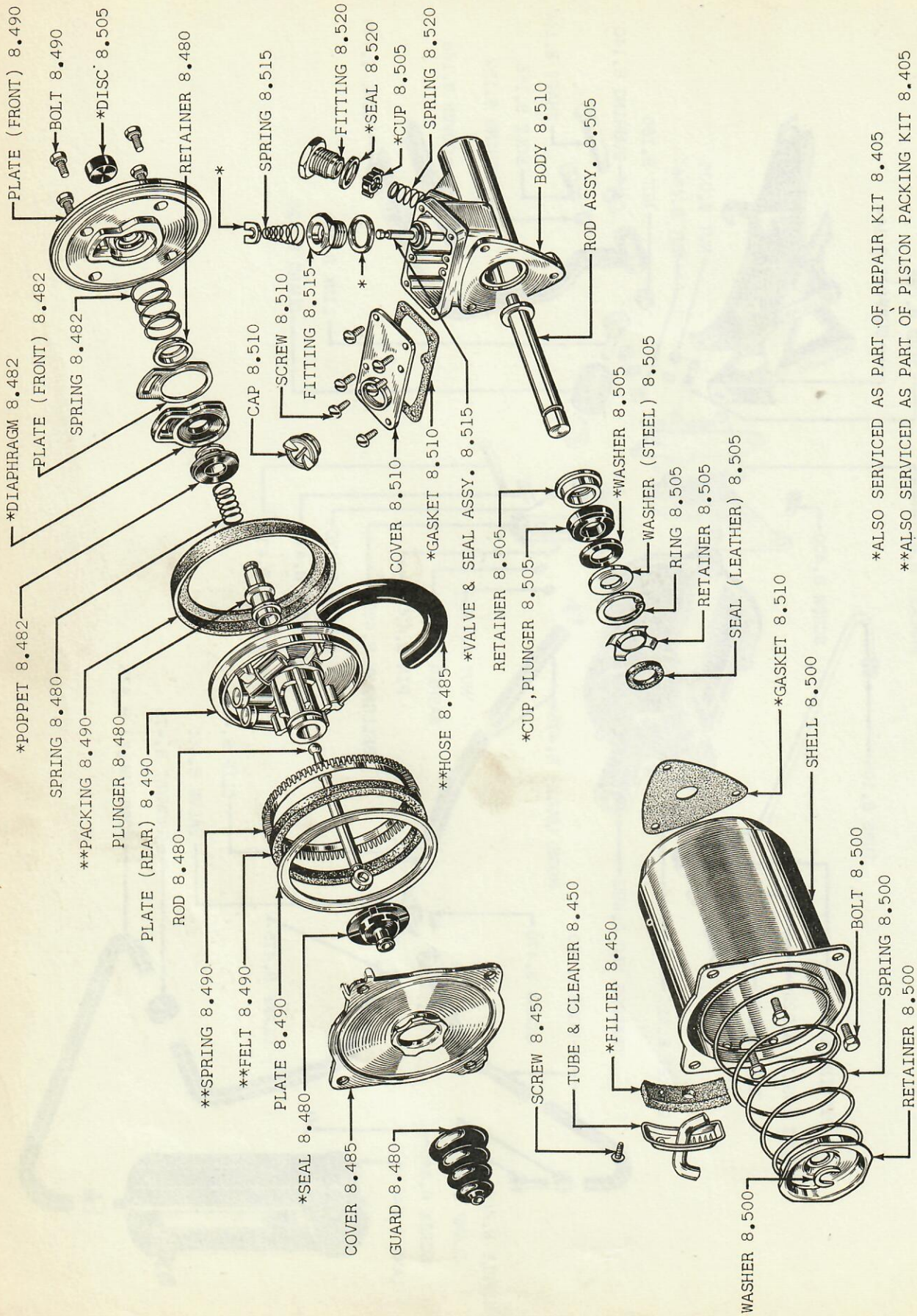

*ALSO SERVICED AS PART OF REPAIR KIT 8.405
 **ALSO SERVICED AS PART OF PISTON PACKING KIT 8.405

GROUP 8 - FIG. 15 - POWER BRAKE TREADLE VAC 10-20-80 (LHD-WPB)

AMERICAN MOTORS PARTS CATALOG

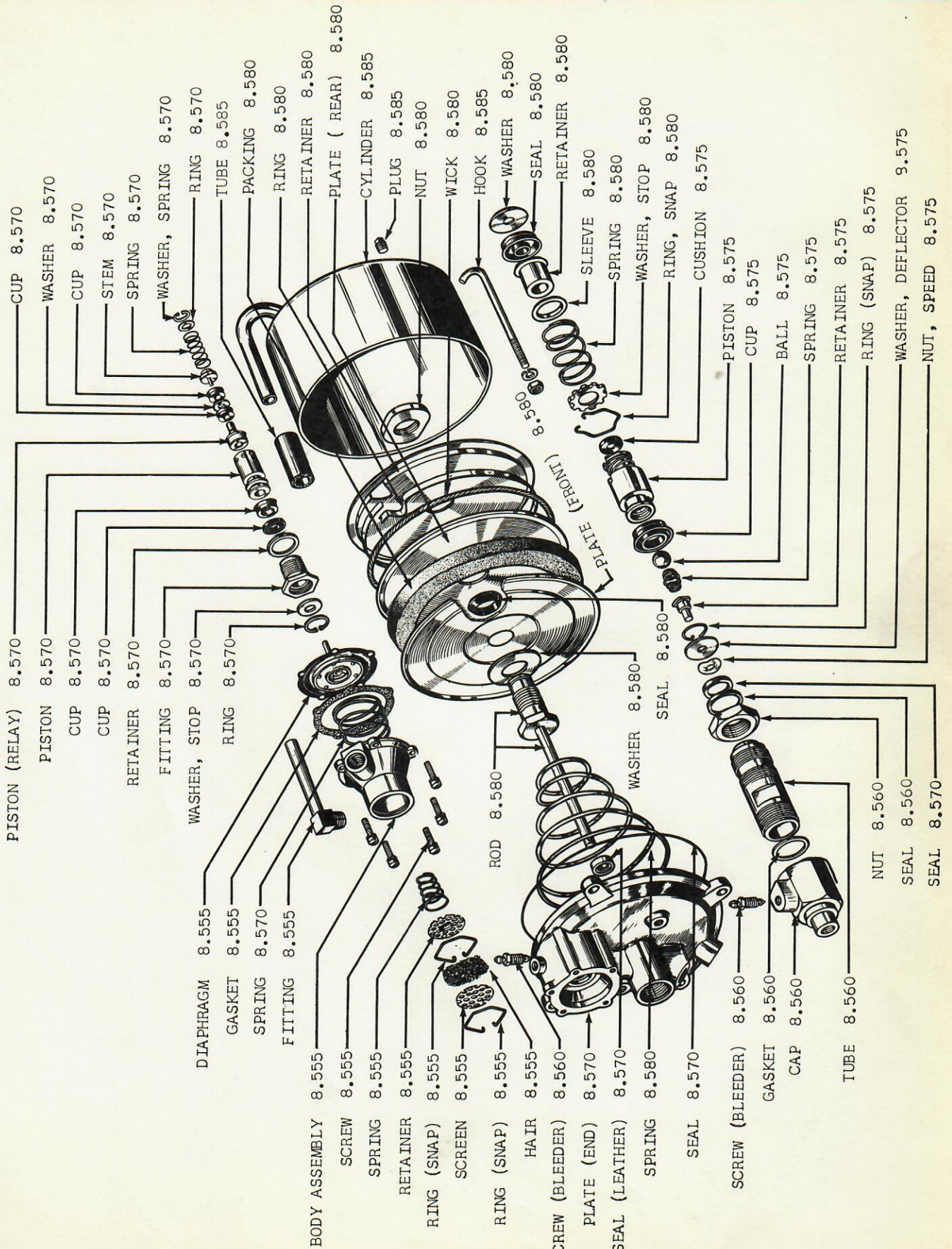

GROUP 8 - FIG. 16 - POWER BRAKE HYDROVAC 10-80 (RHD-WPB)